



SOLUTIONS FOR RAISED FLOORS AND CEILINGS

FIXING SUSPENDED CEILINGS

INSTALLATION SYSTEM
APPLICATIONS

GUARDRAIL

LOAD-BEARING BEAMS

FRAMES FOR EQUIPMENT

CABLE MANAGEMENT SYSTEMS

RAISED FLOOR STAND

STAIRS

FLOOR TILES



ADVANTAGES

- Quick assembly of the structure without welding
- Ease of upgrading the structure at all stages from design to operation, as well as quick dismantling
- A wide range of standard solutions depending on technical conditions: seismic resistance, fire resistance, high corrosion resistance, high loads
- A clear system of elements for various solutions, including non-standard and complex geometry
- Solution to prevent slippage and displacement of roof panels
- Ease of grounding (one point per 10-15 m²);
- Raised floor height from 0.1 to 3 m with a rack pitch of up to 1.8 m and estimated loads on the roof from 500 to 3000 kg/m²

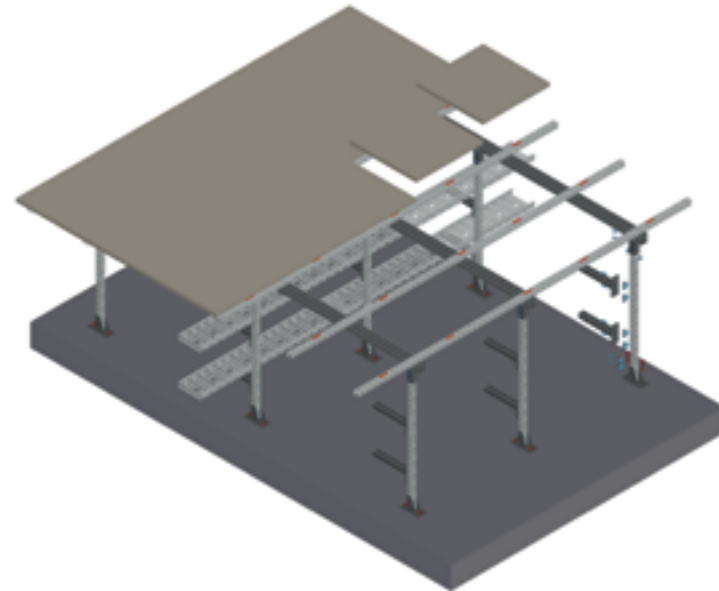

MT-TL NUT AND UNIQUE ADJUSTMENT SYSTEM

All fastenings of structures are carried out with universal nuts, which significantly speeds up the installation speed. The same nut is used for all types of MT profiles. At the installation stage, a specially developed unique technology for assembling the second floor allows not only to significantly increase the load characteristics, but also makes it possible to adjust the floor level with an infinitely small step. Due to the absence of welding and the presence of bolted connections, any elements of the raised floor are dismantled/installed within one minute during subsequent maintenance. This ensures ease of further modernization/operation of the structure.

PROFILES OF VARIOUS SECTIONS AND CONSOLES

The raised floor frame is formed by supporting posts and beams. If there are cable routes, consoles are attached to the posts for further laying of trays or cables. It is possible to install walkways for their maintenance. UTECH raised floor is a single system. It allows you to attach any type of communications in any place of the raised floor without installing additional posts. This saves space and makes it possible to install additional engineering.

REMOVABLE FLOOR TILES

UTECH offers a wide range of floor tiles so that our customers do not have to compromise between design, load requirements, material resistance to aggressive environments and fire safety. The cost-effectiveness of the floor is also due to the possibility of installing tiles with a final coating before finishing the room, since the spatial frame is rigid. The mechanical limitation of the panels from horizontal displacement and the rigidity of the structure make it possible to use the floor even with a partially dismantled coating for access to the underground.



BASIC ELEMENTS

SUPPORT ELEMENTS	PROFILES	BRACKETS
<p>See section «Base plates»</p>	<p>See section «Profiles»</p>	<p>See section «Brackets»</p>

CONNECTORS	CONNECTING ELEMENTS	CABLE TRAYS.. CMS	TILES AND ACCESSORIES
<p>See section «Connectors»</p>	<p>See section «Components»</p>	<p>Contact a UTECH engineer</p>	<p>See section «Elements for raised floors»</p>

RAISED FLOOR SOLUTIONS

UTECH raised flooring is a complete solution that enables the realisation of requests with different parameters

- Floor height from 100 mm to 3,000 mm
- Maximum load 1,500 kg/m²
- Tested fire resistance up to RE90 and earthquake resistance up to 9 points

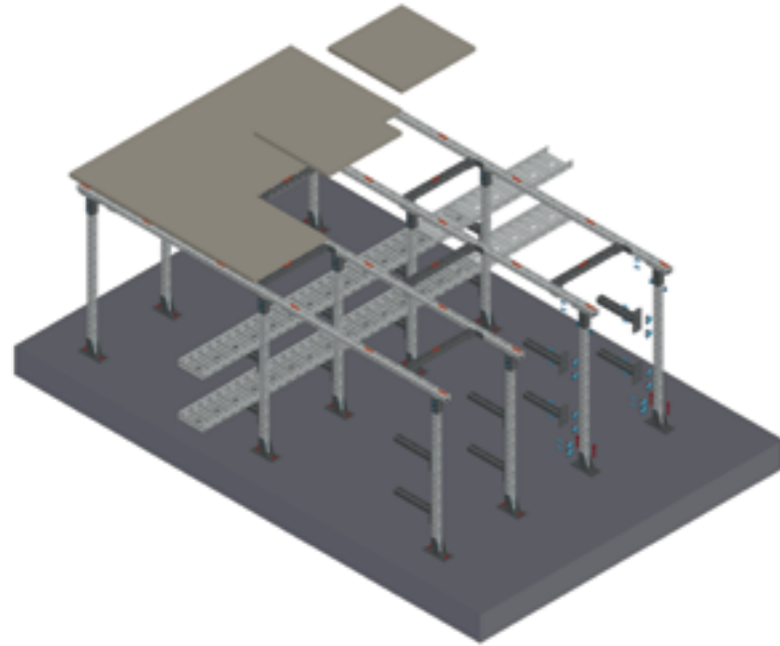

STANDARD SCHEME of main and secondary (bracing) beams on the same level.

The slabs are supported by the main beams:

- ⚠ Simple calculation
- ⚠ Easy installation
- ⚠ Difficult to meet the requirements for wide trays

FLOOR PLAN of load-bearing frames and guide rails for cover slabs:

- ⚠ Cheaper than the standard structure
- ⚠ Easier to bypass tray bends
- ⚠ More difficult to install

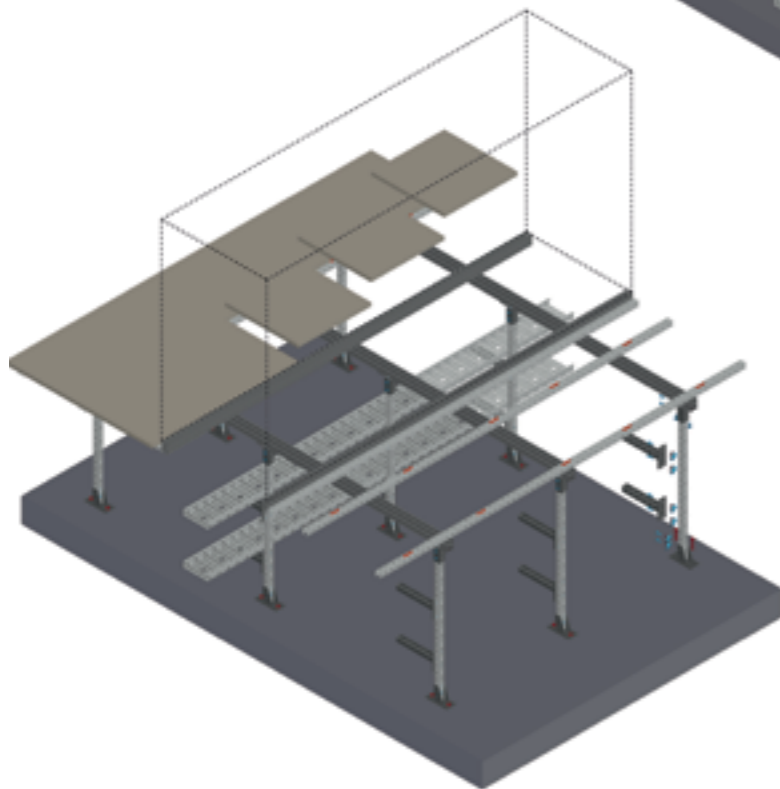
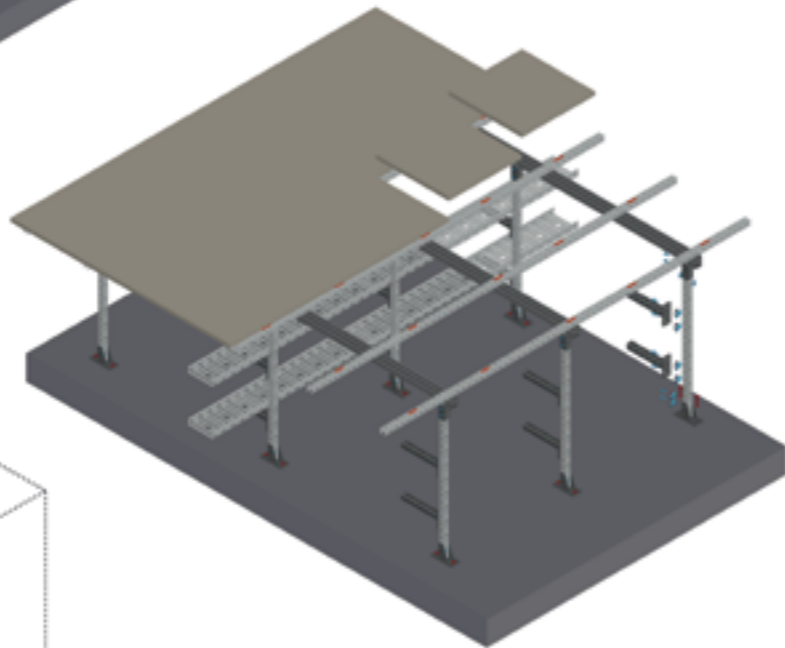

RAIL INSTALLATION OF EQUIPMENT:

- ⚠ Easy installation
- ⚠ Not attached to a specific location
- ⚠ Limited by load

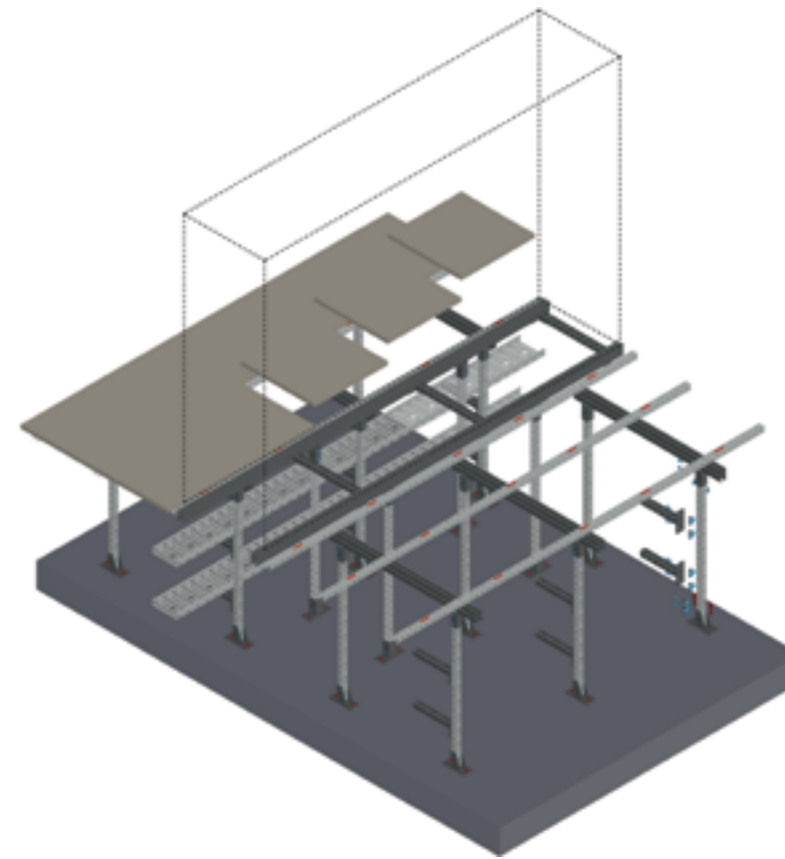

РАМНОЕ КРЕПЛЕНИЕ
ОБОРУДОВАНИЯ

- ⚠ Независимая конструкция
- ⚠ Высокие нагрузки
- ⚠ Постоянное расположение

SUSPENDED CEILING SOLUTIONS

With UTECH false ceilings, the most daring and complex architectural and design tasks can be realised. The solution for fixing networks and siding in a single unit.

